

AXIS

Daniel Hornek P.A.
305-808-7918

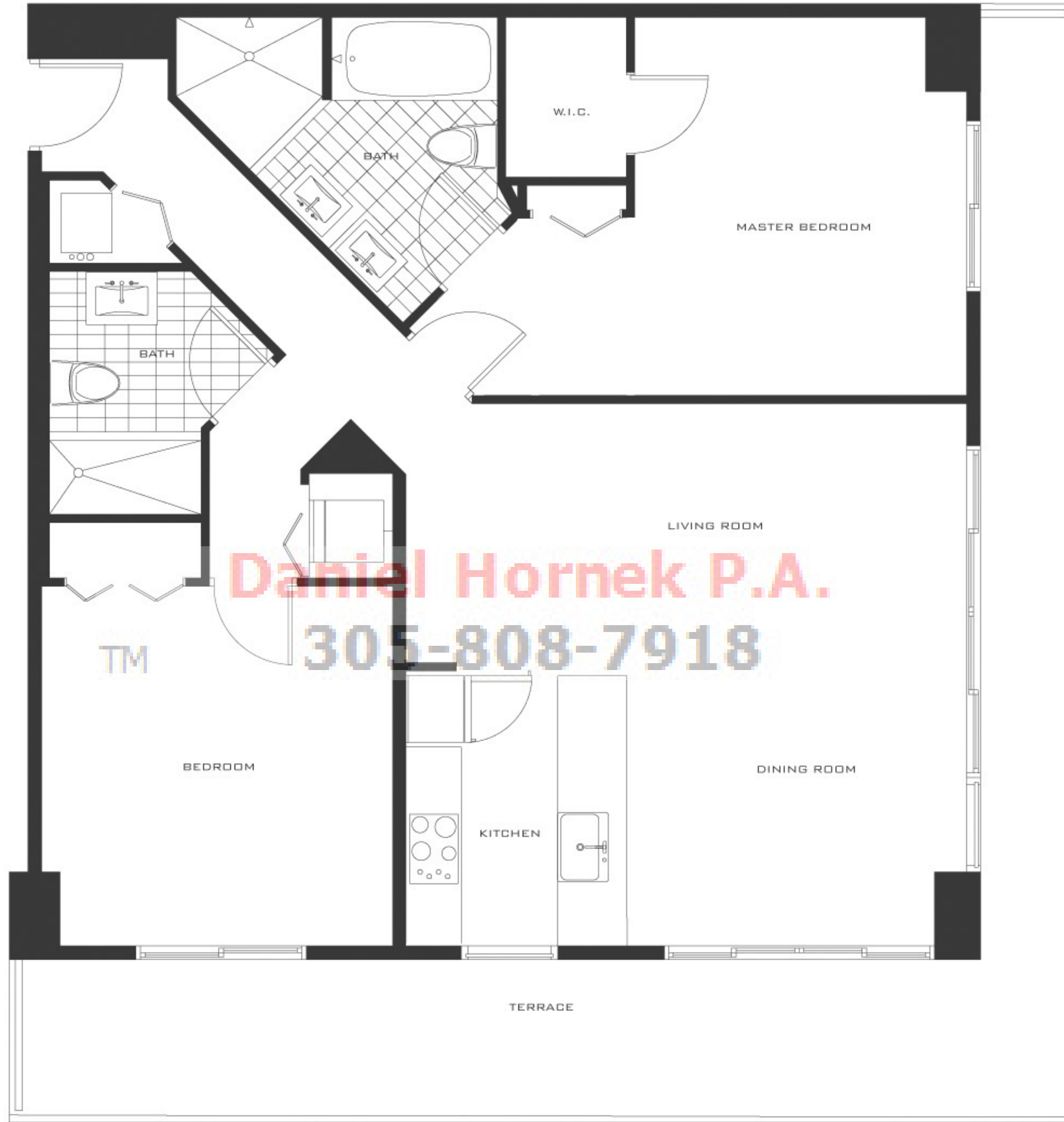

file:///C:/Users/daniel%20hornek/Documents/realtors.txt

Daniel Hornek P.A. 305-808-7918
The Miami Realtors

file:///C:/Users/daniel%20hornek/Documents/realtors.txt/12/17/2007 9:34:40 AM

ORAL REPRESENTATIONS CANNOT BE RELIED UPON AS CORRECTLY STATING REPRESENTATIONS OF THE DEVELOPER. FOR CORRECT REPRESENTATIONS, MAKE REFERENCE TO THIS BROCHURE AND TO THE DOCUMENTS REQUIRED BY SECTION 718.503, FLORIDA STATUTES, TO BE FURNISHED BY A DEVELOPER TO A BUYER OR LESSEE.

This offering is made only by the prospectus for the condominium and no statement should be relied upon if not made in the prospectus. This is not an offer to sell or solicitation of offers to buy the condominium units in states where such offer or solicitation cannot be made. Prices, features, and specifications subject to change without notice.

Dimensions and square footage calculations are approximations only and are based upon architectural measurements which, among other things, measure the Units from the exterior of all perimeter walls (excluding balconies) except for those between two adjacent Units which are measured from the wall's midpoint. As a result, the Developer does not represent or warrant that the actual dimensions and square footage of the Units will be as reflected on floor plans and other promotional materials. This brochure and other marketing materials may use calculations for the square footage of Units in a manner different from that set forth in the Declaration of Condominium, which generally includes only the interior air space between interior unfinished surfaces of the walls bounding the Units.

The size of the balconies for type D and type E units varies significantly since the width of such balconies located along the short side of the building varies significantly depending on the floor level that the unit is located in due to the architectural wave feature of the building.

D 2 BD / 2 BT	Area 1,174 SF / 109 SM NOT INCLUDING BALCONIES
-------------------------	---



EQUAL HOUSING OPPORTUNITY